

# 16/32CH NVR

12MP/8MP/6MP/5MP/4MP/3MP/1080P/960P/720P HD NVR

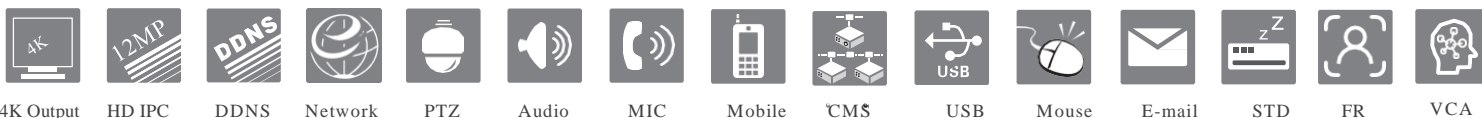

## NGD-8216.5PRO



NGD-8216.5PRO series supports 16/32 CH 12MP / 8MP / 6MP / 5MP / 4MP / 3MP / 1080P / 1280x1024/960P/ 720P high definition IP input, which adopts the advanced SoC technique to ensure high definition recording in each channel and realize outstanding robustness of the system.

NGD-8216.5PRO series supports 16/32CH IPC input, simultaneous 16CH playback, and 4K high definition display. The series of product can meet different security requirements of home, financial, commerce, enterprise, transportation and government, etc.



## SPECIFICATIONS

Model		NGC-8216.5PRO	NGC-8232.5PRO
System	OS	Embedded Linux	
Video	Compression	H.265S/H.265+/H.265/H.264	
	IP Video Input	16CH IPC input	32CH IPC input
	Resolution	12MP/8MP/6MP/5MP/4MP/3MP/1080P/1280×1024/960P/720P/960H/D1/CIF	
	Network Bandwidth	160Mbps/160Mbps (incoming/outgoing)	192Mbps/192Mbps (incoming/outgoing)
	Output	HDMI1 : 3840 × 2160/1920 × 1080 / 1280 × 1024 / 1024 × 768 HDMI2 : 1920 × 1080 / 1280 × 1024 / 1024 × 768 VGA ×1 : 1920 × 1080 / 1280 × 1024 / 1024 × 768 VGA and HDMI1 output the same video source	
Audio	Network Input	16 CH IPC audio input	32 CH IPC audio input
	2-way Audio	RCA × 1	
	Local Output	RCA × 1	
	Compression	G.711(U/A)	
Record	Record Stream	Dual stream recording	
	Resolution	12MP/8MP/6MP/5MP/4MP/3MP/1080P/1280×1024/960P/720P/960H/D1/CIF	
	Frame Rate	NTSC: 30fps; PAL: 25fps	
Playback	Simultaneous Playback	Max 16CH	
	Search	Time slice / time / event / tag / smart search	
	Smart Search	Highlighted color to display the camera record in a certain period of time, different colors refers to different record events	
	Function	Play, pause, FF, FB, digital zoom, etc.	
Decoding Capability	Live View/ Playback	1CH 12MP/4CH 1080P	
Multi-Screen Display Mode	Mode	Dual output mode (default mode): supports HDMI2 output, but doesn't support AI by device AI mode: HDMI2 output and 12MP video input (live view/playback) are unavailable, but 8MP video input supports	
	Dual Output Mode	16CH (HDMI1) +9CH (HDMI2)	32CH (HDMI1) +4CH (HDMI2)
	AI Mode	16CH(HDMI1)	24CH (HDMI1)
Alarm	Mode	Manual, sensor, motion, exception, smart events, etc.	
	Input	8 CH local alarm input	
	Output	4 CH	
	Triggering	Record, snap, preset, e-mail, etc.	
Face	Face Detection Performance (AI by IPC)	16CH	32CH
	Face Detection Performance (AI by Device)	2 CH (2MP)	
	Face Match Performance	6 CH	
	Comparison Capability	18 pictures / second	
	Face Picture Database	32 libraries 10000 Face Pictures	
	Face Picture Search	Search by picture is supported	
	Database Management	Add, modify, delete and search face pictures	
	Face Picture Adding	Add face pictures through APP, WEB and external import	
	Face Picture Comparison	Support allow list, block list and stranger match alarm	
	Track	Track display on a map	

Face	Statistical Graph of Information	Bar graph	
	Statistical Mode of Information	Statistics by day, week, month, quarter as well as customized time period	
Video Structure Analysis	Human/Vehicle Classification	Yes	
Other Functions	Fisheye	Supports fisheye dewarping via Web Client and mobile APP	
	Plate Recognition	Yes	
Network	Interface	RJ 45 1000 Mbps × 2	
	Protocol	TCP / IP, PPPoE, DHCP, DNS, DDNS, UPnP, NTP, SMTP, HTTP, HTTPS, 802.1x, RTSP, SNMP, ONVIF, etc.	
	Client Connection	Max. 10 users access	Max. 20 users access
Mobile Device	OS	iOS, Andriod	
Storage	HDD Interface	SATA × 2, max 10T for each HDD	
Backup	Local Backup	U disk, USB mobile HDD	
	Network Backup	Yes	
External Interface	RS 485	Yes (full-duplex), connect to PTZ or keyboard	
	USB	USB 3.0 × 1 ; USB 2.0 × 2	
	Remote Controller	Optional	
Others	Power Supply	DC12V/4A	
	Consumption	≤ 20W ( without HDD )	
	Certificate	CE, FCC	
	Environmental Protection	Complies with Directive EU RoHS, REACH and WEEE	
	Dimensions(mm)	380 × 268 × 45 ( W × D × H )	
Working Environment	-10 ~ 50 °C, 10% ~ 90% humidity		

## FEATURES

- Support 16/32CH 12MP/8MP/6MP/5MP/4MP/3MP/1080P/1280×1024/960P/720P/960H/D1/CIF IPC Input
- H.265S/H.265+/H.265/H.264
- Intuitive and user-friendly Graphic User Interface ( GUI ), Windows style operation by mouse
- Multi-type recording: manual / timed / motion / sensor / POS / AI recording
- Playback : 16 CH simultaneous playback
- Search : time slice, time, event, tag and smart search
- Support face detection and comparison
- Support multiple VCA (Video Content Analytics) events, such as object abandoned/missing, region intrusion, tripwire, video exception, etc.
- Support license plate recognition
- Support POS information overlay on live view and playback
- Pentaplex : preview, record, playback, backup and remote access
- DHCP, DDNS, PPPoE network protocol
- Compatible with third-party IPCs, such as ONVIF, Hikvision, etc.
- Remote control via Web Client or CMS : preview, playback, backup, PTZ and configuration
- Dual stream technology for local storage with high definition, remote network transmission and remote surveillance with mobile device
- Multi-user online simultaneously
- Authorization management, log view and device status view
- 4K output, true high resolution display
- Support PTZ preset and auto cruise, up to 255 presets and 8 cruises
- Support NAT function and QRCode scanning by mobile phones
- Powerful mobile surveillance by smart phones with iOS and Andriod OS

## DIMENSIONS

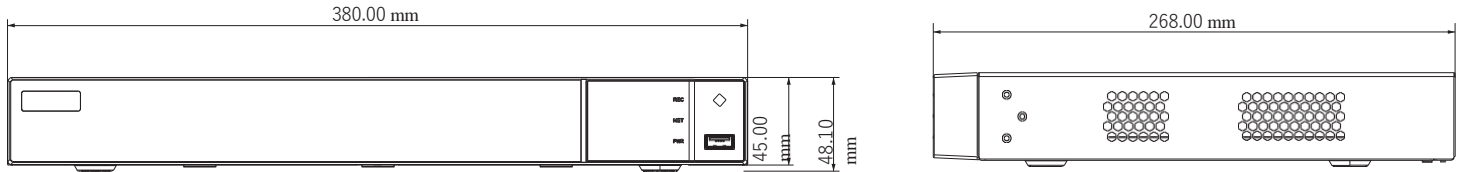

## REAR PANEL

