

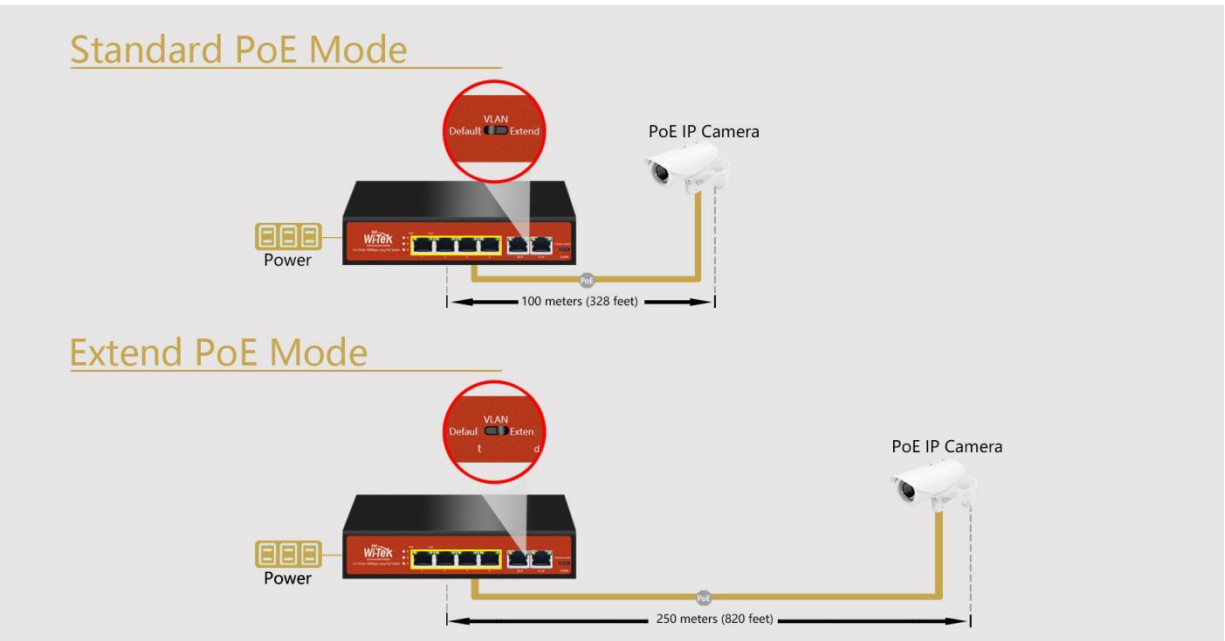

WI-PS208H
8-Port 48V 100Mbps economical PoE
Switch with 8-Port PoE Data sheet

Monitors compliant PD with smart watchdog function.

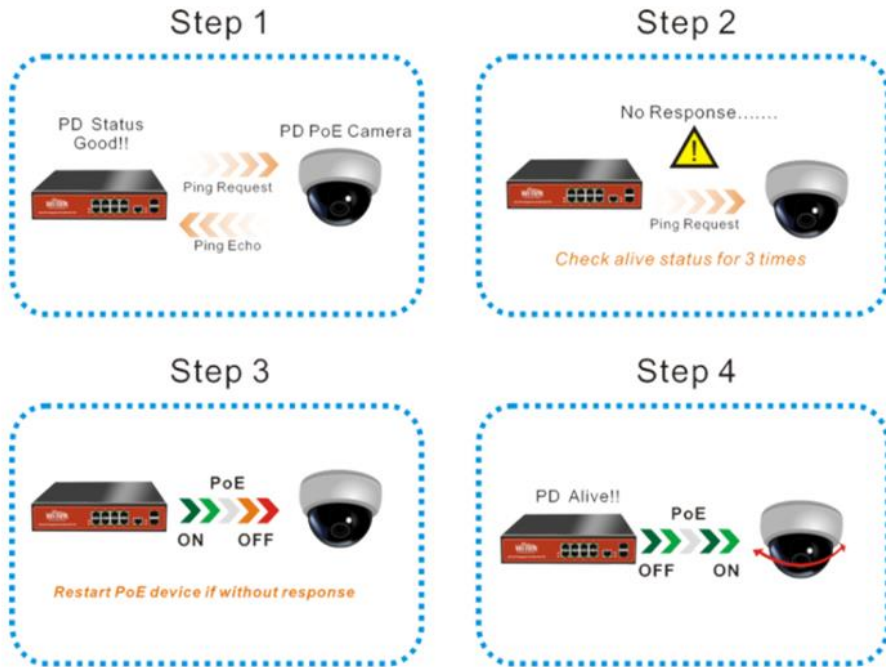

Description

what this product does

WI-PS208H is a 8-port 10/100Mbps unmanaged switch that requires no configuration and provides 8 PoE ports. The switch provides an easy way to expand your wired network. All 8 ports support auto-MDI/MDIX, eliminating the need to worry about the type of cable to use. Featuring full duplex mode, the WI-PS208H can process data at a rate of up to 200Mbps making it an ideal choice for expanding your high performance wired network. Moreover, with innovative energy-efficient technology, the WI-PS208H can save up to 68% of power consumption, making it an eco-friendly solution for your home or office network. WI-PS208H also support PoE Watchdog function which will detect Camera or Wireless AP system halted then restart PoE Port automatic to alive halted device;

High Performance

WI-PS208H Fast Ethernet Switch provides 8 10/100Mbps Auto-Negotiation RJ45 ports. All ports support Auto MDI/MDIX function, eliminating the need for crossover cables or Uplink ports. Featuring non-blocking switching architecture, WI-PS208H forwards and filters packets at full wire-speed for maximum throughput. And IEEE 802.3x flow control for Full Duplex mode and backpressure for Half Duplex mode alleviate the traffic congestion and make WI-PS208H work reliably.

Easy to Use

The auto features of this Ethernet switch make installation plug and play and hassle-free. No configuring is required. Auto MDI/MDIX eliminates the need for crossover cables. Auto-negotiation on each port senses the link speed of a network device (10, 100 Mbps) and intelligently adjusts for compatibility and optimal performance.

Specifications

HARDWARE FEATURES

Interface	8 10/100Mbps RJ45 Ports
Network Media	10/100BASE-TX: UTP category 5 or better (maximum 250m)
Fan Quantity	Fanless
Power Consumption	65W (max. with PoE device connected)
Power Supply	Internal Power Adapter(Output: DC52V 1.25A)
PoE Ports (RJ45)	Standard: 802.3 af/at compliant PoE Ports: Port1- Port8
Backplane Bandwidth	16Gbps
Mac Address Table	4K
Packet Forwarding Rate	1.2Mpps
Buffer	768Kbps
Jumbo Frame	10240Bytes
Dimensions	190mm*130mm*35mm (L*W*H)

HARDWARE FEATURES

Protection Leve	Lightning protection 6KV 6KV ESD Contact discharge
----------------------------	---

SOFTWARE FEATURES

Transmission Method	Store-And-Forward
Advanced Functions	Priority Function Mac Address Auto-Learning And Auto-Aging Store and forward IEEE 802.3x flow control for Full-duplex Mode Backpressure for Half-duplex Mode

OTHERS

Certification	CE, FCC, RoHS
Package Contents	POE Switch Electric Line Guide Book/Warranty Card
Environment	Operating Temperature: -10°C~55°C



WIRELESS-TEK TECHNOLOGY LIMITED

www.wireless-tek.com

Email: sales@wireless-tek.com

Technical Support: tech@wireless-tek.com