

Hardware

Camera (SpotCam HD, SpotCam HD Pro)

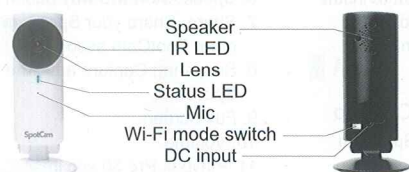

- Accessory
1. Power cable
2. Wall mount kit

EN

FR

DE

JP

TC

Camera (SpotCam HD Eva)

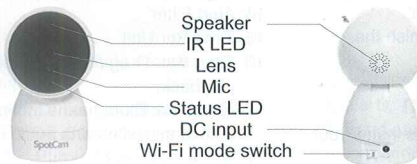

- Accessory
1. Power cable
2. Wall mount kit

Disclaimer

The information contained in this document is for product operation instruction. SpotCam does not make any representations, warranties or guarantees, express or implied, as to the accuracy or completeness of the manual. Users must be aware that updates and amendments will be made from time to time to the manual. It is the user's responsibility to determine whether there have been any such updates or amendments. Neither SpotCam nor any of its directors, officers, employees or agents shall be liable in contract, tort or in any other manner whatsoever to any person for any loss, damage, injury, liability, cost or expense of any nature, including without limitation incidental, special, direct or consequential damages arising out of or in connection with the use of the manual.

Note: Please keep SpotCam out of reach of children.

Installation

Registration: Register on SpotCam web site <http://www.myspotcam.com>

Note: Please check your spam if you don't receive activated mail.

First Installation on Web Page



1. Power on your SpotCam.
2. Connect to SpotCam web site and click "ADD SPOTCAM".
3. Execute the tool "Add_SpotCam" which downloaded from SpotCam web site.
4. Click "Let's Get Started".
5. Login your SpotCam account.
6. Follow setup wizard to finish the installation.

First Installation on Android App



1. Download and execute SpotCam Android App.
2. Login your SpotCam account.

3. Extend the menu which in your App then click "Add SpotCam".
4. Confirm whether you want to install SpotCam under this account.
5. Follow setup wizard to finish the installation.

First Installation on IOS App

1. Download and execute SpotCam IOS App.
2. Login your SpotCam account.
3. Extend the menu which in your App then click "Add SpotCam".
4. Follow setup wizard to finish the installation.

Camera Installation

You can use wall mount kit to install your SpotCam on wall or ceiling

SpotCam HD/HD Pro

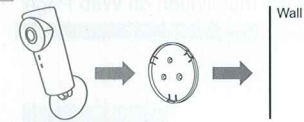

SpotCam Eva

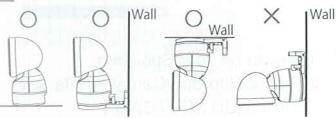

User Interface

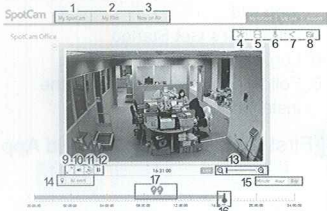

1. My SpotCam: Shows all SpotCam which install under your account.
2. My Film: Shows all time-lapse and normal video you made.
3. Now on Air: Shows all SpotCam which set at public.
4. Setting: Setup all camera function (Next chapter).

5. Make Film: Make time-lapse or normal video from record data
6. Speak: Start two way audio.
7. Share: Share your SpotCam image to other SpotCam account.
8. Snapshot: Capture a picture from SpotCam.
9. Full Screen
10. Volume
11. Play/Pause Pre 30 sec image
12. Play/Pause image
13. Digital Zoom in/out
14. Alert Filter
15. Time Bar Unit
16. Time Bar: Drag red icon to start playback.
17. Alert Icon: Blue means motion detection, red means audio detection.

Functionality

General Setting



1. Camera: On->Enable camera, Off->Disable camera
2. Camera Sleep: The "Alerts" function should enable first.
 - 2.1 The "Set" icon will appear after this function is enabled
- 2.2 User can setup wakeup condition for camera
3. Camera Schedule: Disable camera stream in specific time.

- 3.2 In this page, user can let camera disable the live stream and choose which days you want to apply this schedule.

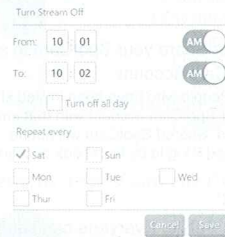

4. 180°Rotation: Rotate camera image 180°.
5. Status LED: Turn on/off status LED
 - 5.1 LED Off: SpotCam is off now.
 - 5.2 Solid Purple (Solid blue & orange): SpotCam is in booting up process.
 - 5.3 Blinking in orange: SpotCam is working in Wi-Fi AP mode.
 - 5.4 Blinking Blue Fast: SpotCam is working in client mode and connected to your Wi-Fi already and is trying to connect to cloud server.
 - 5.5 Blinking Blue Slowly: SpotCam is working in client mode, but it cannot connect to your Wi-Fi router.
 - ▲ Note: Camera LED will blink blue once per second when blink fast and once every two seconds when blink slowly
 - 5.6 Solid Blue: SpotCam is working normally.
6. HD Resolution: Disable this function to switch to SD(640X480).
7. Night Vision: Default is in auto mode, can also turn on/off by manually.
8. Flicker Reduction: Select correct electrical frequency depends on your location.
9. Audio: Turn on/off micon camera.
10. Mic Sensitivity: Adjust mic sensitivity on camera.
11. Wi-Fi Network -> Switch camera to AP mode and reinstall again if you want to change your Wi-Fi connection.

12. Time Zone: Select the correct time zone to display correct time.
13. NVR Plan: Upgrade your SpotCam to 1/3/7/30 days NVR plan.

Alerts



1. Alerts: Turn on/off this function.
2. Send Alerts When: Setup a condition for sending alert.
3. Motion Sensitivity: Adjust sensitivity of motion detection, higher sensitivity means smaller changes can trigger motion alert.
4. Motion Mask: Select the zone where motion should be ignored within.
 - 4.1 The "Set" icon will appear after this function is enabled.
 - 4.2 Select the zone where motion should be ignored within.
5. Sound Sensitivity: Adjust sensitivity of audio detection.
6. Send Alerts To: Send message to specific email when event triggered.
 - ▲ Note: It's only available on web interface if you want to add another email address.
7. Alerts Schedule: Disable alert function in specific time.
 - 7.1 The "Set" icon will appear after this function is enabled



7.2 Setup a time period let camera disable alert function and select which days you want to apply this schedule.

8. Pan/Tilt Control - Web Interface



Click to open control penal.

- App Interface

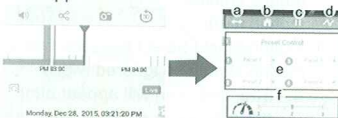

Click to open control penal

Pan/Tilt Control:

- Web Interface: Drag central point to control the camera
- App Interface: Use 1 finger slide on screen
 - a. Auto Pan: Make camera continuously pan
 - b. Home: Make camera return to home position
 - c. Pause: Stop current patrol
 - d. Patrol: Camera will follow preset points to patrol
 - e. Preset Point: Press "+" to add current position as a preset point. Up to 4 preset points can be saved
 - f. Pan/Tilt Speed: Adjust speed of camera pan and tilt

- ⚠ Note: Pan/Tilt control is not available when camera is zoomed
- ⚠ Note: Camera will bounce back when moving up/down/left/right to the edge of moving range
- ⚠ Note: Camera will save current position as next boot up position after stay still for 2 minutes

Sharing



1. Share: Share your SpotCam to specific SpotCam account

⚠ Note: People who have been invited should register SpotCam account with that email address. Shared SpotCam will not be displayed if log in by Facebook account.

Public

1. Make Public: Everyone can see your SpotCam image, your SpotCam will be list in Now on Air list.

Share my SpotCam video on MySpotCam.com

2. Share On: You can also share your SpotCam image to Facebook or Twitter.



Make Film

1. Normal Video: Select the period you want to save with the yellow bar.



⚠ Note: The maximum length for single file is 10 minutes.

2. Time-Lapse: Make time-lapse from your record data.

2.1 You can make time-lapse from all record data or select the period by yourself.

2.2 Choose photo-taking interval.

Photo-taking Interval:

2.3 We will calculate and display video length before you export it.

Estimated maximum video length: 0 Hours 0 Minutes 4 Seconds

Technical Support

If you need further assistance, please contact us at: support@mynspotcam.com
 You can also visit our technical center for help. <http://www.mynspotcam.com/welcome/support>