

# NAT SLIM

**INTERNAL AND EXTERNAL CURTAIN SENSOR**



**Installation manual**

## INDEX

1	LIST OF COMPONENTS	Pag. 3
2	ASSEMBLY	Pag. 4
3	ELECTRONIC BOARD	Pag. 7
4	COMPONENT DESCRIPTION	Pag. 8
5	FUNCTIONS DESCRIPTION	Pag. 9
6	CALIBRATION	Pag. 9
7	APPLICATION EXAMPLES	Pag. 10
8	TECHNICAL FEATURES	Pag. 12

### ***NB: Suggestions for installation***

NAT SLIM is an infrared detector with a curtain effect that is used to protect the inputs.

In order to ensure correct performance, doors, and windows must be installed on the upper part of the frame to detect the movement of a stranger through the entrance.

NAT SLIM **does not need to be installed:**

- in locations where it is hit by direct sunlight
- in positions where it is hit by reflected light

## 1 LIST OF COMPONENTS

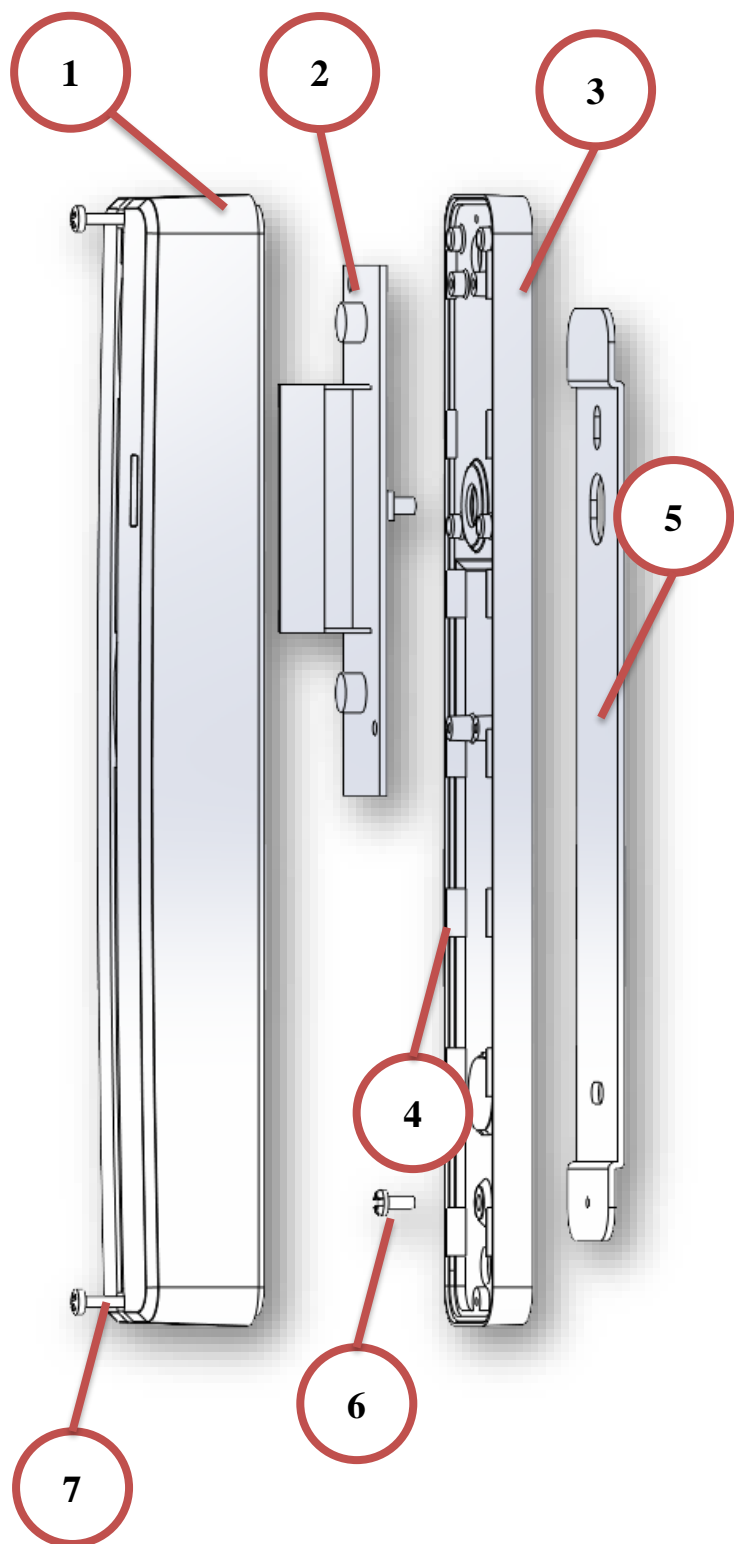

- 1 Cover
- 2 Electronic board
- 3 Support base
- 4 TX Radio board slot
- 5 Fixing plate
- 6 Fixing screws
- 7 Closing screws

## 2 ASSEMBLY

1. Position the fixing plate in the center of the upper jamb of the window or door to be protected and mark the position of the fixing holes. Once the holes have been made, attach the fixing plate. Tighten the screws firmly to prevent the device from moving.

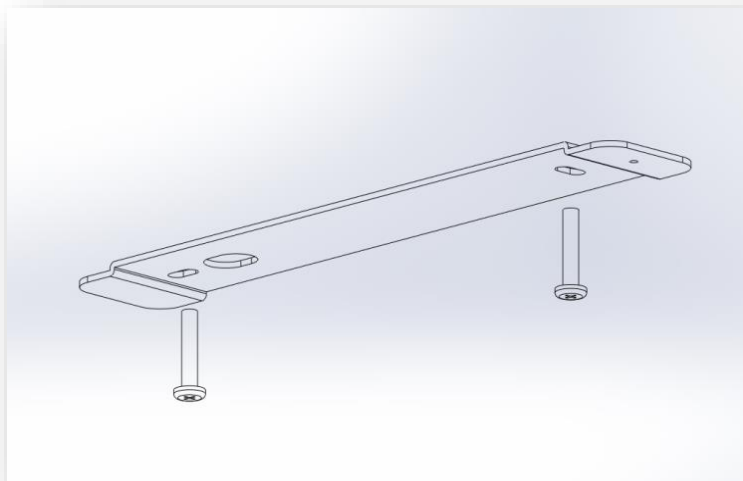

2. When the mounting plate is fixed, insert the side of the base with the stopper

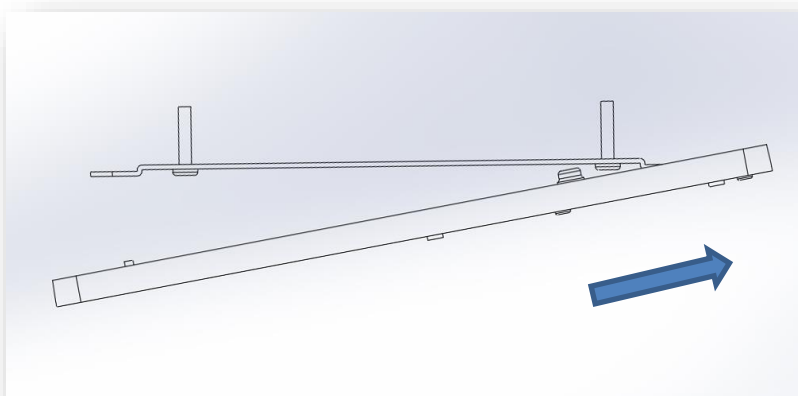

taking care not to push too far to avoid breaking the stop.

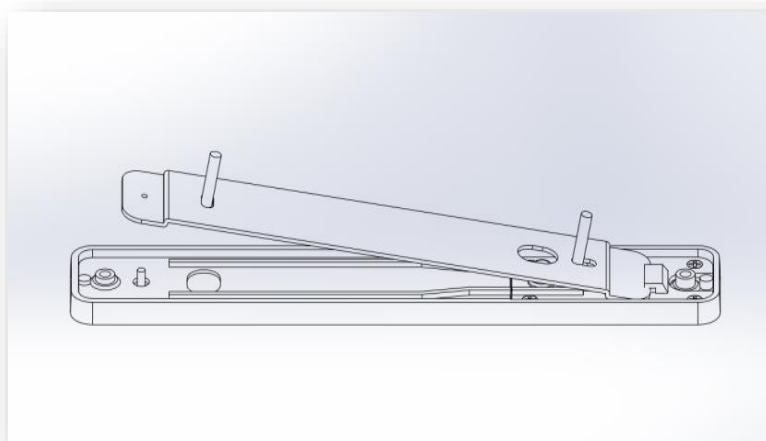

3. Once inserted, return the base to a horizontal position

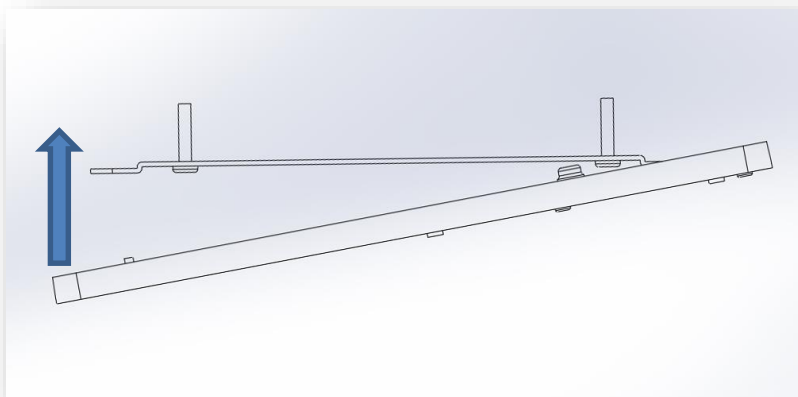

matching the base to the fixing plate.

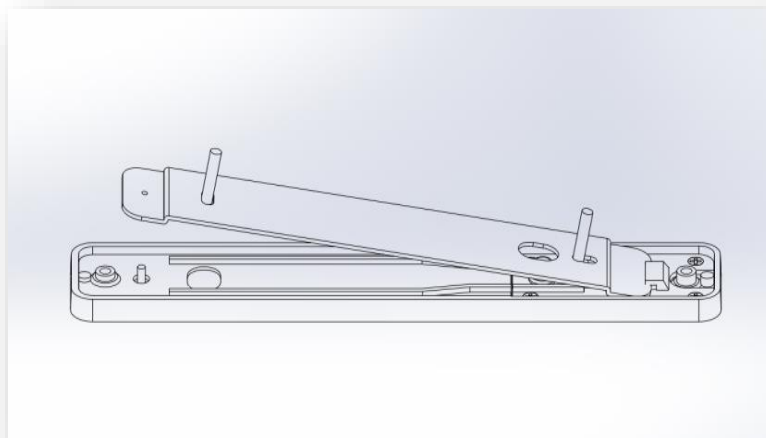

4. When assembled correctly you should see the base of the NAT SLIM positioned like this:

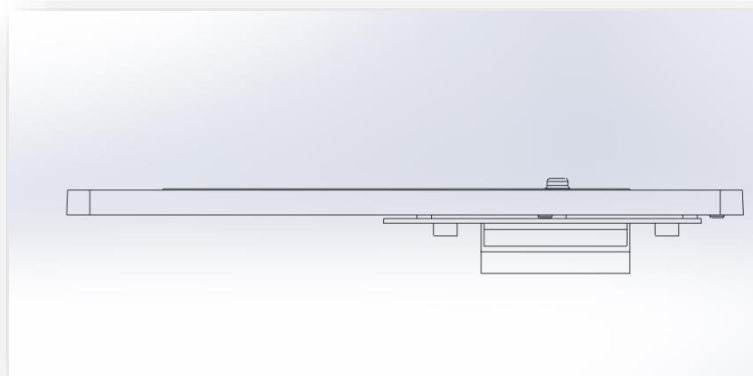

5. Make sure that it is firm, place the lid by applying it with a slight upward pressure.

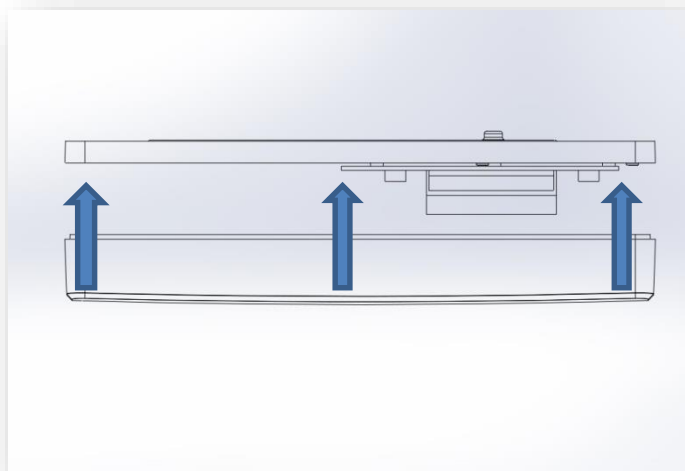

6. To hide and protect the screws, insert the plugs into the appropriate holes.

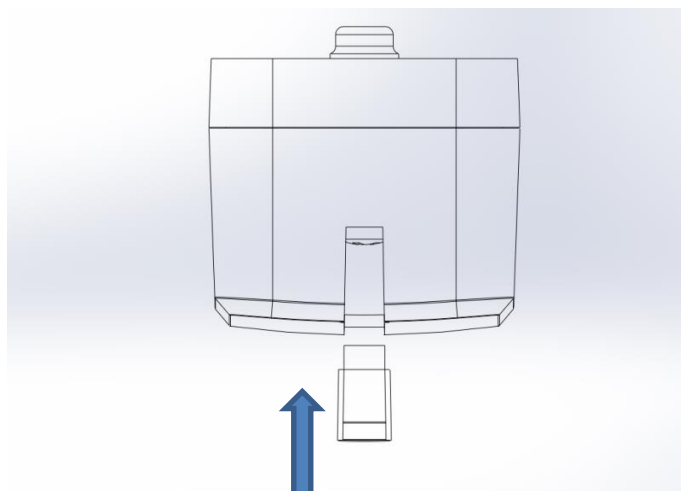

## 3 ELECTRONIC BOARD

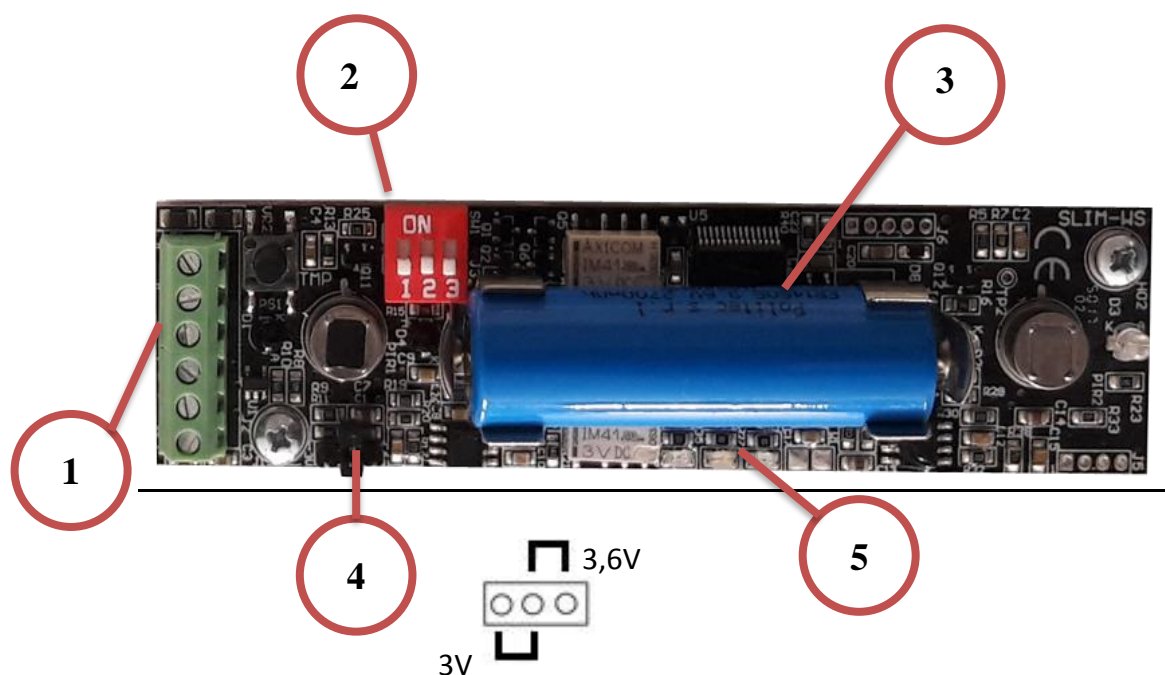

<b>1 TERMINAL</b>	<b>1</b>		
	<b>2</b>	<b>TMP</b>	Output tamper
	<b>3</b>		
	<b>4</b>	<b>ALM</b>	Output alarm
	<b>5</b>	<b>-</b>	Negative power supply output for radio transmitter
	<b>6</b>	<b>+</b>	Positive power supply for radio transmitter
<b>2</b>	<b>DIP DI TEST</b>		
<b>3</b>	<b>BATTERY</b>		
<b>4</b>	<b>JUMPER POWER SUPPLY TRANSMITTER 3v/3.6v</b>		
<b>5</b>	<b>SIGNAL LED</b>		

## 4 COMPONENTS DESCRIPTION

### 1. TERMINAL:

Tamper and alarm outputs with NC-free contacts, with possibility of balancing on the terminal board.

### 2. DIP DI TEST

1	2	RANGE
OFF	OFF	0.5M
OFF	ON	1.5M
ON	OFF	2.5M
ON	ON	4M

DIP 3: ON for activation of anti-masking function.

Anti-masking outlet in series at the TAMPER output

### 3. BATTERY: 3.6v 2.7Ah average duration 3 years

### 4. JUMPER: output power for radio transmitter

### 5. SIGNAL LED

**LED RED**

Sensor in ALARM (operation in AND between the two IR)

**LED BLUE**

Right IR sensor in Alarm

**LED YELLOW**

Left IR Sensor in Alarm

**FLASHING**

Simultaneous blinking BLU-YELLOW: Masked sensor (only if active antimask function)



## 5 FUNCTIONS DESCRIPTION

- **Operation in AND**  
The sensor sends an alarm signal only when both infrared signals have detected an intrusion signal
- **ANTIMASKING function**  
If the function is enabled, the system detects within 20 seconds if even one of the two IR sensors is masked.  
The output appears to be in series with the TAMPER.
- **Thermal Self-Compensation**  
The sensor adapts its sensitivity dynamically depending on the ambient temperature
- **Anti blindness**  
The sensor detects sudden and sudden changes in light, re-adapting its sensitivity
- **Pet Immunity for animals <5kg (height installation minimum 2.2m)**  
The sensor performs an analysis of the mass detected in order to identify more accurately the presence of people or animals

## 6 CALIBRATION



1. Select DIP 1-2 properly depending on the installation height
2. Check the lighting and flashing of the LEDs when the sensor is turned on
3. Close the cover
4. Perform crossing tests
5. After 5 minutes of operation the LEDs will turn off automatically

## 7. APPLICATION

NAT SLIM is a sensor that can be installed both outdoors and indoors to protect doors, windows, doors, “french doors”.

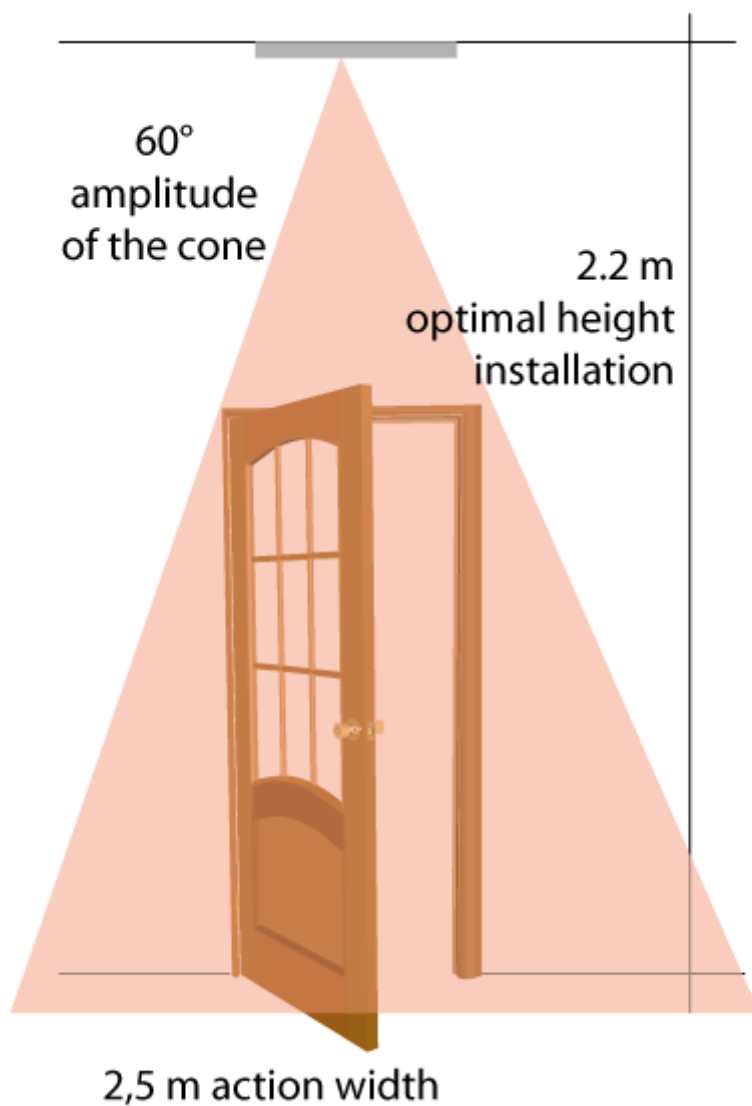

Height installation	Detection width
2m	2.3m
2.5m	2.8m
3m	3.5m
4m	4.5m



External application on the door



Application on industrial door



External application on door and balcony

## 8. TECHNICAL CHARACTERISTICS

<b>MAXIMUM COVERAGE RANGE</b>	Adjustable up to 4 m. of height
<b>SENSOR CALIBRATION AND PROGRAMMING</b>	On board
<b>3 SIGNAL LEDS</b>	
<b>OPENING ANGLE</b>	60 ° horizontal, 5 ° vertical
<b>SUPPLY</b>	3,6 V
<b>AUTONOMY</b>	3 years with battery 3,6V 2,7Ah
<b>CONSUMPTION</b>	0.05 mA at rest / 0.8 mA in alarm
<b>OUTPUT</b>	Alarm (NC) Cover anti-removal tamper (NC) Antimask in series at Tamper
<b>DIMENSIONS (LxPxH)</b>	234 x 39 x 35 mm
<b>DIMENSIONS FOR RADIO TRANSMITTER</b>	100 x 31 x 24 mm
<b>MATERIAL</b>	Scratch-resistant polycarbonate, resistant to uv
<b>PROTECTION DEGREE</b>	IP 65
<b>OPERATING TEMPERATURE</b>	
<b>MOUNTING KIT</b>	Includes screws and metal plate
<b>WARRENTY</b>	2 years

**TECHNICAL SUPPORT: +39 039 9081616**