

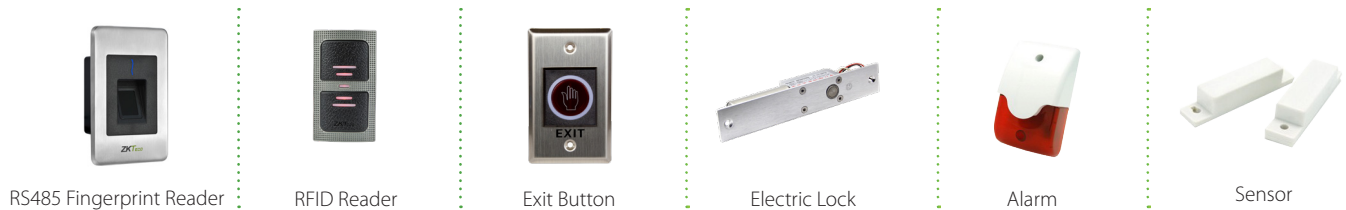

# Specifications

Display	2.4-inch TFT LCD Color Screen
Fingerprint Capacity	3000
Card Capacity	5000(Optional) ID or mifare card
Transaction Capacity	30,000
Sensor	SilkID Sensor
Algorithm Version	ZKFinger VX10.0
Communication	RS232/485, TCP/IP, USB-host,Wi-Fi
Access Control Interface	3rd Party Electric Lock, Door Sensor, Exit Button, Alarm
Wiegand Signal	Input, Output
Aux. Input	1ea for linkage function
Functions	DST, Automatic Status Switch, Record query, T9 input, 14 digit user ID, Anti-passback, Scheduled-Bell, Printer(Optional), ADMS(Optional)
Power Supply	12V DC,3A
Operating Temperature	0 °C- 45 °C
Operating Humidity	20%-80%
Dimension(LxWxH)	158.5x78.0x19.4mm
SDK and software	Standalone SDK,ZKAccess3.5 software

# Optional Accessories



# Configuration

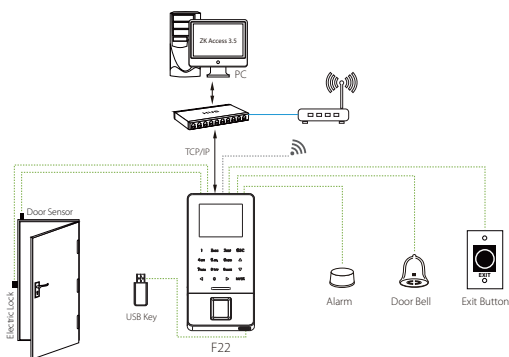

# Dimensions (mm)

