

Quick Installation Guide V1.0.0



CAUTION

- Please make sure the mounting surface is strong enough to hold at least three times of the camera weight.
- Keep the protection film on the dome before installation and adjustment finished to avoid possible scratch.



NOTE

For wooden mounting surface, expansion bolts are optional.

Model A

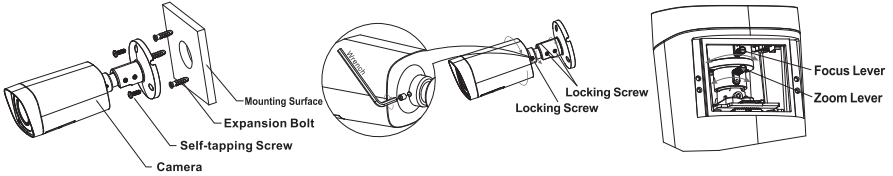

Model B and Model C

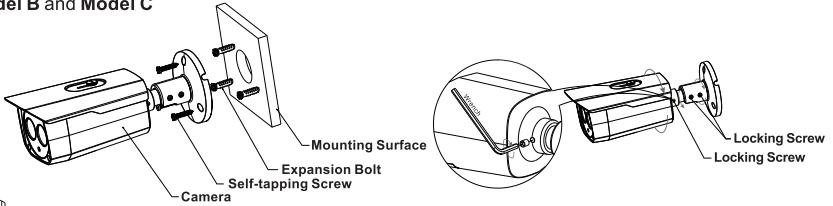

NOTE

Model B and C have the same structure but different layout of IR LEDs.

Model D

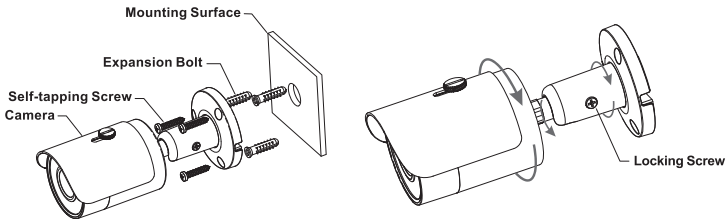

Model E

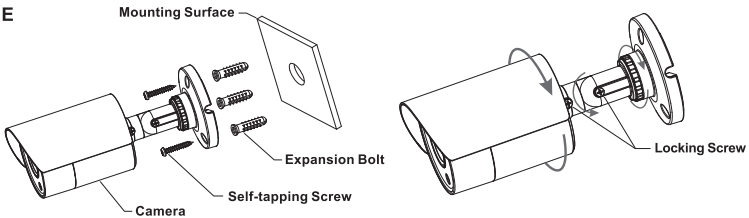

Model F

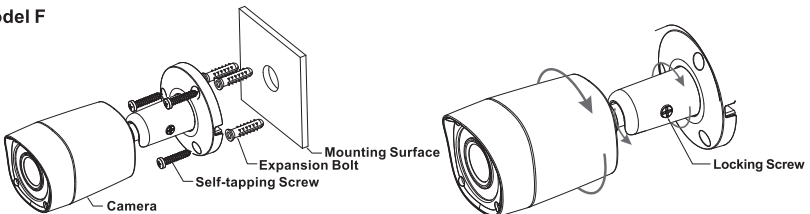

Model G

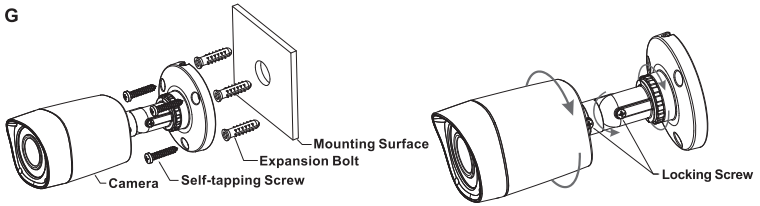

Model H

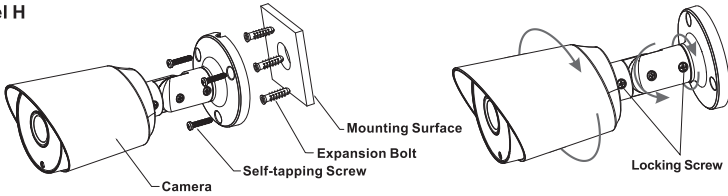

Model I

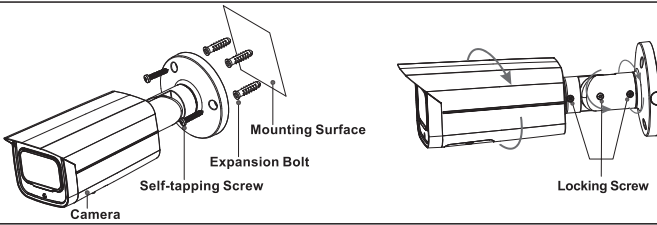

Model J

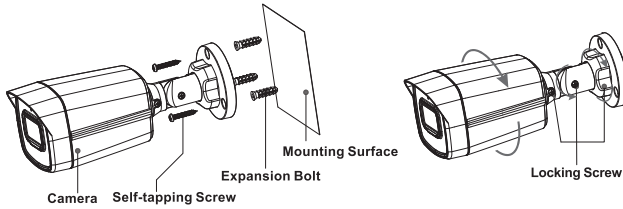

Model K

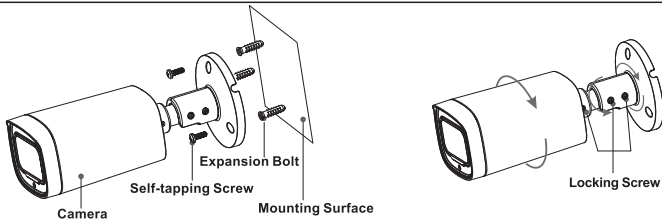

Model L

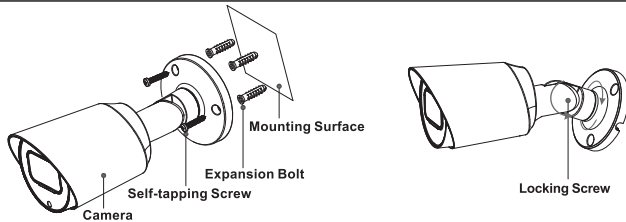

NOTE

This manual is for reference only. Please visit our website or contact your local service engineer for more information.